

2 Bed Flat In Plough Road , London, SW11 2AL

£2,150 Monthly





SHORT DESCRIPTION

Property Ref: 12772 Charming ground floor flat, featuring two spacious double bedrooms and conveniently located near the scenic River Thames and vibrant Clapham Junction. Within close proximity to the station for easy access to London Victoria, London Waterloo, Brighton, and Gatwick Airport. Explore the local charm with nearby shops, bars, and restaurants on St. Johns Hill and Northcote Road, offering a variety of options for entertainment and dining, as well as the wide open spaces of Clapham and Wandsworth Common only a short distance away.... Property Type: Flat Full Renting price: £2150.00 Pricing Options: Fixed Price Tenure: 12 months Council tax band: C EPC rating:D Measurement: 656.599 Sq.ft. Outside Space: Rear Garden Parking: On street Heating Type: Gas Central Heating -----

2

Bed Room(s)

1

Bath Room(s)

1

Living Room(s)

FLOOR PLAN

Illustrations are for identification purposes only and are not to scale.
All measurements are a maximum and include wardrobes and bay windows where applicable.

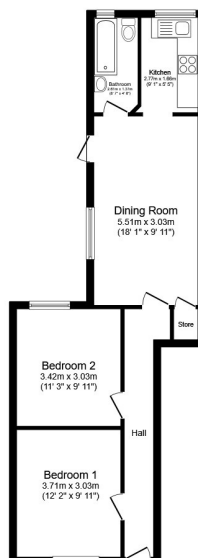

Total floor area 55.7 m² (599 sq.ft.) approx

This floor plan is for illustrative purposes only. It is not drawn to scale. Any measurements, floor areas (including any total floor area), openings and orientation are approximate. No details are guaranteed, they cannot be relied upon for any purpose and they do not form part of any agreement. No liability is taken for any error, omission or misstatement. A party must rely upon its own inspection(s). Powered by www.focalagent.com

EPC GRAPH

Energy rating and score

This property's energy rating is D. It has the potential to be C.

[See how to improve this property's energy efficiency.](#)

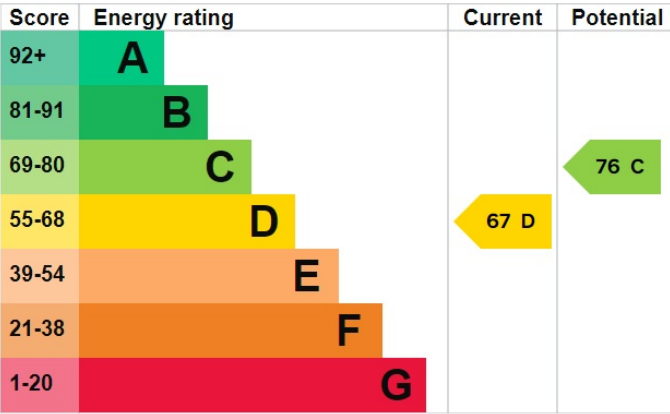

The graph shows this property's current and potential energy rating.

Ac
Go

Disclaimer: The information displayed about this property comprises a property advertisement. 99home.co.uk (/) will not make no warranty for the accuracy or completeness of the advertisement or any linked or associated information, and 99home has no control over the content. This property advertisement does not constitute property particulars, the property may offer to tenants in same condition as they have seen on time of the viewing. The information is provided and maintained by 99home.co.uk (/)