

## 3 Bed Flat In Parliament View Apartments 1 Albert Embankment, London, SE1 7XQ

£4,900 Monthly



Ref:14296







## SHORT DESCRIPTION

Property Ref: 14296 A stunning three double bedroom apartment spanning approximately 1206 sq. ft with a view of Parliament. The apartment offers a modern open plan kitchen/ reception room with fully integrated appliances, spacious principle bedroom with built in storage and modern en-suite shower room, and contemporary family bathroom. The property has the added benefit of 24-hour concierge service and gym within the building. The development is within easy reach to Vauxhall station and Westminster. Property Type: Flat Full selling price: £4900.00 Pricing Options: No Status Council tax band: G EPC rating:C Measurement: Total 1097.919 sq.ft. Outside Space: N/A Parking: Allocated Heating Type: Gas Central Heating Chain Sale or Chain Free: N/A Possession of the property: N/A -----

3

Bed Room(s)

2

Bath Room(s)

1

Living Room(s)

## FLOOR PLAN

Illustrations are for identification purposes only and are not to scale.  
All measurements are a maximum and include wardrobes and bay windows where applicable.

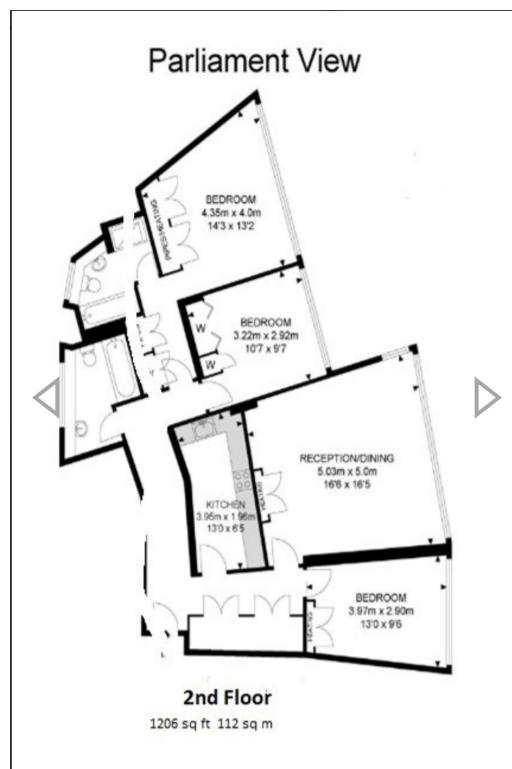

## EPC GRAPH

## Energy rating and score

This property's energy rating is C. It has the potential to be C.

[See how to improve this property's energy efficiency.](#)

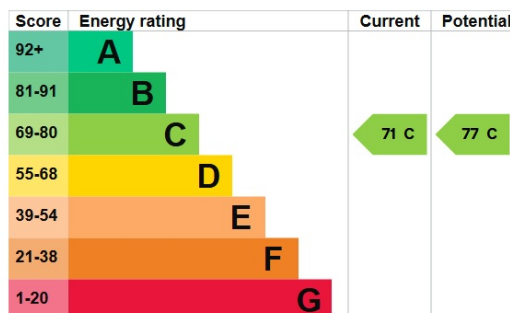

The graph shows this property's current and potential energy rating.

**Properties get a rating from A (best) to G (worst) and a score.** The better the rating and score, the lower your energy bills are likely to be.

For properties in England and Wales:

- the average energy rating is D
- the average energy score is 60

**Disclaimer:** The information displayed about this property comprises a property advertisement. 99home.co.uk (/) will not make no warranty for the accuracy or completeness of the advertisement or any linked or associated information, and 99home has no control over the content. This property advertisement does not constitute property particulars, the property may offer to tenants in same condition as they have seen on time of the viewing. The information is provided and maintained by 99home.co.uk (/)