

2 Bed Flat In 15 Acock Grove Acock Grove, Northolt, UB5 4RT

£145,000





SHORT DESCRIPTION

Property Ref: 14448 We are pleased to present an exceptional Flat located at Northolt, UB5. This wonderful residence boasts 2 bedrooms, 1 bathroom, and 1 living room, offering ample space for comfortable living. Additionally, it features a fully-fitted kitchen, ideal for culinary enthusiasts, along with the convenience of a Communal Garden and Allocated parking. Positioned in a prime location, this property offers easy access to a range of local amenities and public transportation, ensuring convenience for residents. Its proximity to esteemed schools and a college enhance its appeal, providing families with access to excellent educational opportunities.... This residence embodies the perfect blend of comfort, convenience, and quality living, making it an ideal choice for discerning individuals or families seeking a place to call home.... Close to Piccadilly and Central Lines (ten-minute walk), Mainline at the end of the road into Central London in 15 minutes. Easy access to Central London by car via A40 which is a 5-min drive. Local high street or short bus ride to Harrow town center. Close to both Primary and Secondary schools. Will benefit from a new lease on completion of sale. Property Type: Flat Full selling price: £290,000.00 Tenure: Leasehold Remaining lease (In Year): 107 Yearly Ground Rent Cost: £0.00 Yearly Management Cost: £251.76 Council tax band: C EPC rating: C Measurement: Total 570.487 sq.ft. Possession of the property: Occupied.

2

Bed Room(s)

1

Bath Room(s)

1

Living Room(s)

FLOOR PLAN

Illustrations are for identification purposes only and are not to scale.
All measurements are a maximum and include wardrobes and bay windows where applicable.

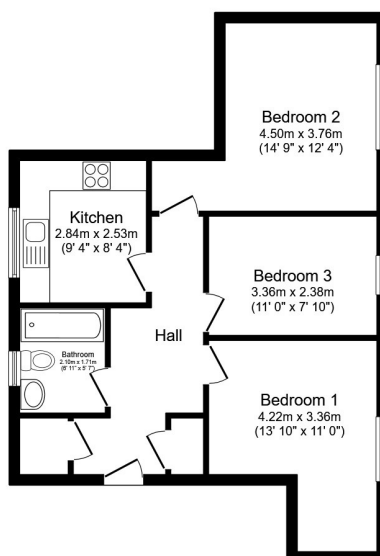

Total floor area 55.5 m² (597 sq.ft.) approx

This floor plan is for illustrative purposes only. It is not drawn to scale. Any measurements, floor areas (including any total floor area), openings and orientation are approximate. No details are guaranteed, they cannot be relied upon for any purpose and they do not form part of any agreement. No liability is taken for any error, omission or misstatement. A party must rely upon its own inspection(s). Powered by www.focalagent.com

EPC GRAPH

Illustrations are for identification purposes only and are not to scale.

All measurements are a maximum and include wardrobes and bay windows where applicable.

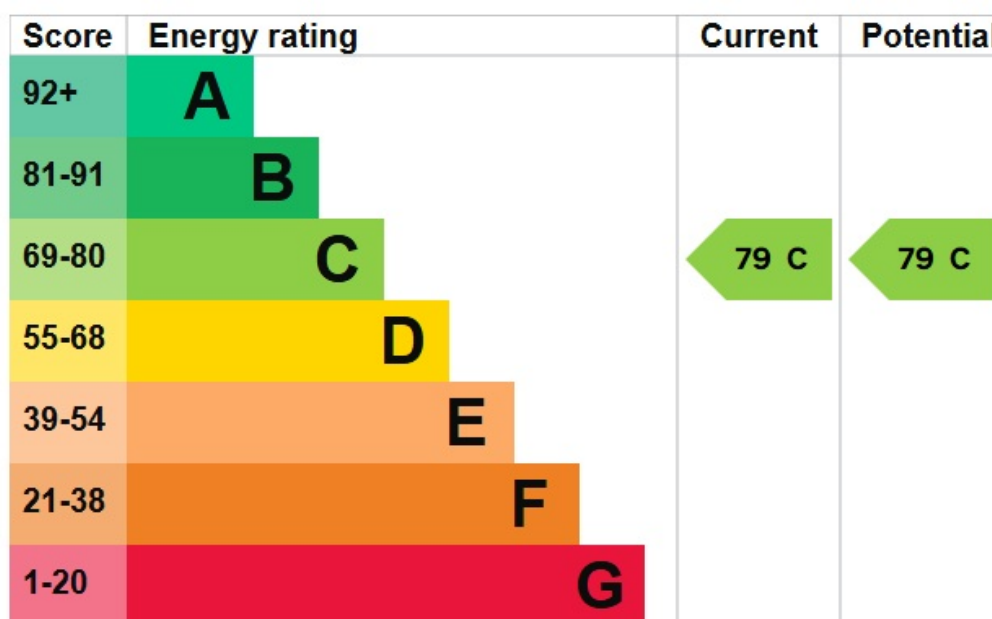

The graph shows this property's current and potential energy rating.

Disclaimer: The information displayed about this property comprises a property advertisement. 99home.co.uk (/) will not make no warranty for the accuracy or completeness of the advertisement or any linked or associated information, and 99home has no control over the content. This property advertisement does not constitute property particulars, the property may offer to tenants in same condition as they have seen on time of the viewing. The information is provided and maintained by 99home.co.uk (/)

