

2 Bed Bungalow In Stubbington Close Willenhall, Willenhall, WV13 3QF £195,000





SHORT DESCRIPTION

Property Ref: 14520 To the fore : Large off road parking and lawned garden Entrance hall Having radiator, doors to various rooms, store housing the boiler Bedroom 1 : 10' 2" x 9' 6" (3.10m x 2.89m) Having double glazed bow window to the front, radiator Bedroom 2 : 9' 2" x 6' 6" (2.79m x 1.98m) Having double glazed window to the front, radiator Bathroom : Having walk in shower, pedestal wash hand basin, low flush wc, tiled floor, tiled walls, double glazed window to the side, loft access Lounge : 15' 9" x 10' 10" (4.80m x 3.30m) Having French doors to deck area to the rear, radiator Kitchen : 8' 9" x 8' 6" (2.66m x 2.59m) Having wall and base cupboard units with work surface, single drainer bowl and a half sink unit, fitted oven, Hob & Extractor, radiator, double glazed window to the rear, door to the rear Outside Rear lawned garden with patio area Ramp from back door deck area to side gate. Property Type: Bungalow Full selling price: £195000.00 Tenure: Freehold Council tax band: A EPC rating: C Measurement: 508 sq.ft. Outside Space: Front Garden, Rear Garden, Enclosed Garden, Patio Parking: Driveway Heating Type: Double Glazing, Gas Central Heating Chain Sale or Chain Free: Chain Free Possession of the property: Vacant ...

2

Bed Room(s)

1

Bath Room(s)

1

Living Room(s)

FLOOR PLAN

Illustrations are for identification purposes only and are not to scale.
All measurements are a maximum and include wardrobes and bay windows where applicable.

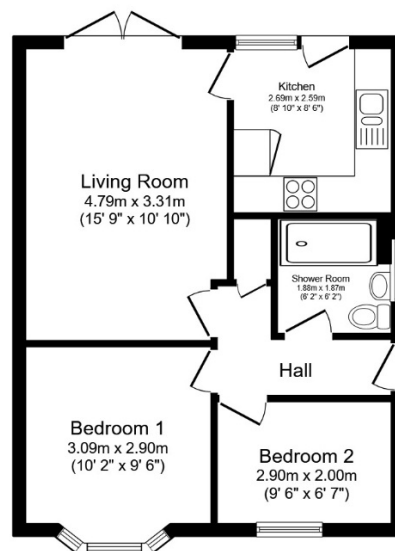

Total floor area 47.2 m² (508 sq.ft.) approx

This floor plan is for illustrative purposes only. It is not drawn to scale. Any measurements, floor areas (including any total floor area), openings and orientation are approximate. No details are guaranteed, they cannot be relied upon for any purpose and they do not form part of any agreement. No liability is taken for any error, omission or misstatement. A party must rely upon its own inspection(s).

EPC GRAPH

Illustrations are for identification purposes only and are not to scale.
All measurements are a maximum and include wardrobes and bay windows where applicable.

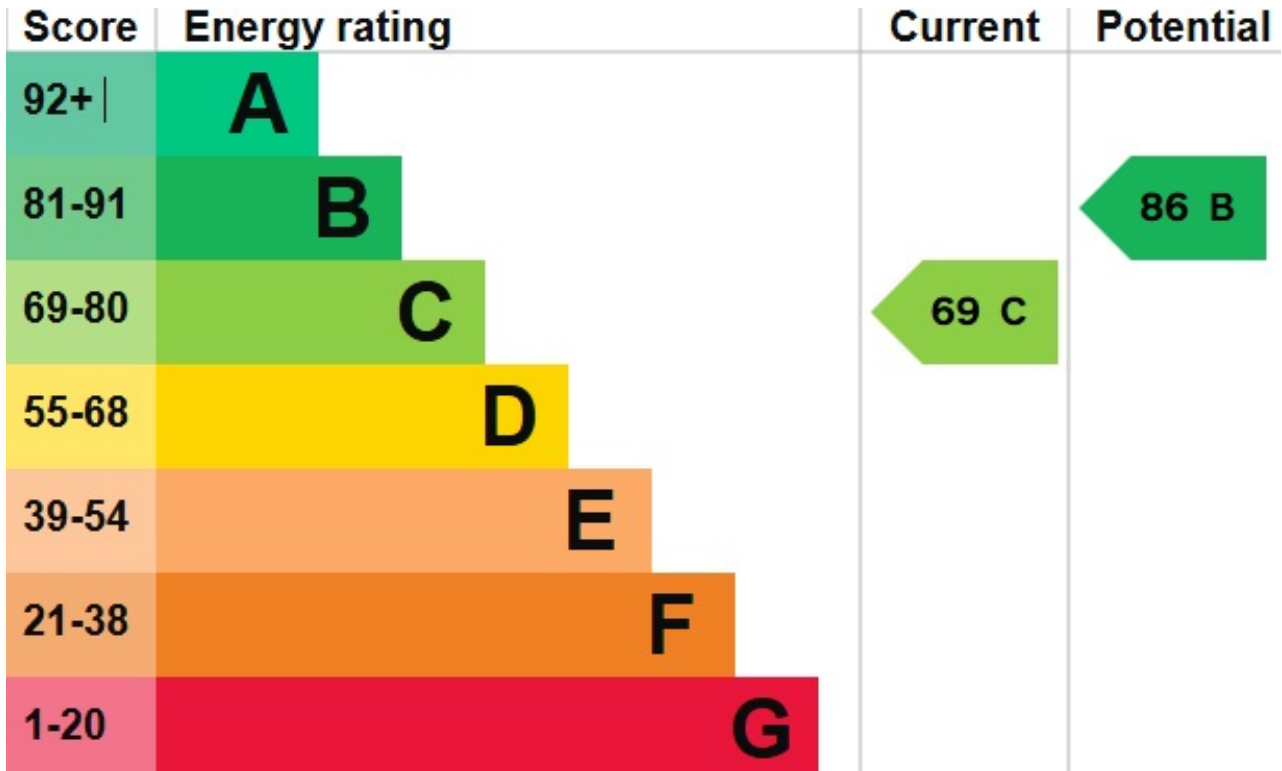

Disclaimer: The information displayed about this property comprises a property advertisement. 99home.co.uk (/) will not make no warranty for the accuracy or completeness of the advertisement or any linked or associated information, and 99home has no control over the content. This property advertisement does not constitute property particulars, the property may offer to tenants in same condition as they have seen on time of the viewing. The information is provided and maintained by 99home.co.uk (/)

Company registration number in England : 10469887 VAT: 263 3023 36
Copyright © 99Home Limited 2017. All rights reserved.