

0 Bed Flat In Hillsborough Court Mortimer Crescent, London, NW6 5NR

£1,700 Monthly

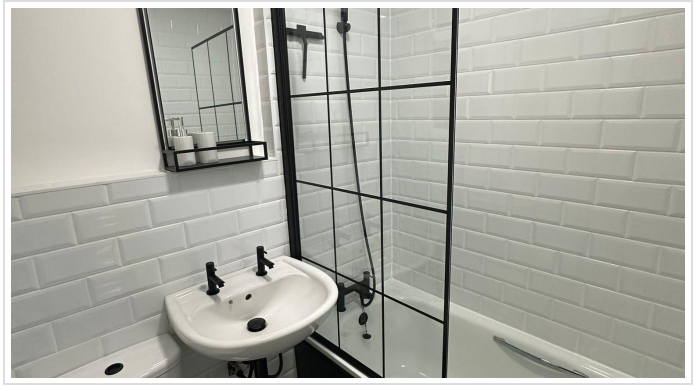



SHORT DESCRIPTION

Property Ref: 15324 This bright and well-designed studio flat makes the most of its space, with defined zones for sleeping, dining, and relaxing—giving it the feel of a one-bedroom. Recently refurbished with a clean, contemporary look, it's perfect for a single professional or couple seeking comfort and style. Set within a quiet development with a shared courtyard, it also includes heating and hot water in the rent—making life that bit easier. Just 5 minutes from Kilburn High Road Station - Lioness line, and 8 minutes from Kilburn Park Station - Bakerloo line, you're well connected while enjoying a peaceful base close to local cafés, shops, and green spaces. Property Type: Studio Monthly rental price: £1700.00 Pricing Options: Offers in excess of Tenure: 12 months Council tax band: C EPC rating: D Measurement: 398.265 sq.ft. Outside Space: Communal Garden Parking: Resident Permit, On street Heating Type: Gas Central Heating -----



Bed Room(s)



Bath Room(s)



Living Room(s)

FLOOR PLAN

Illustrations are for identification purposes only and are not to scale.
All measurements are a maximum and include wardrobes and bay windows where applicable.

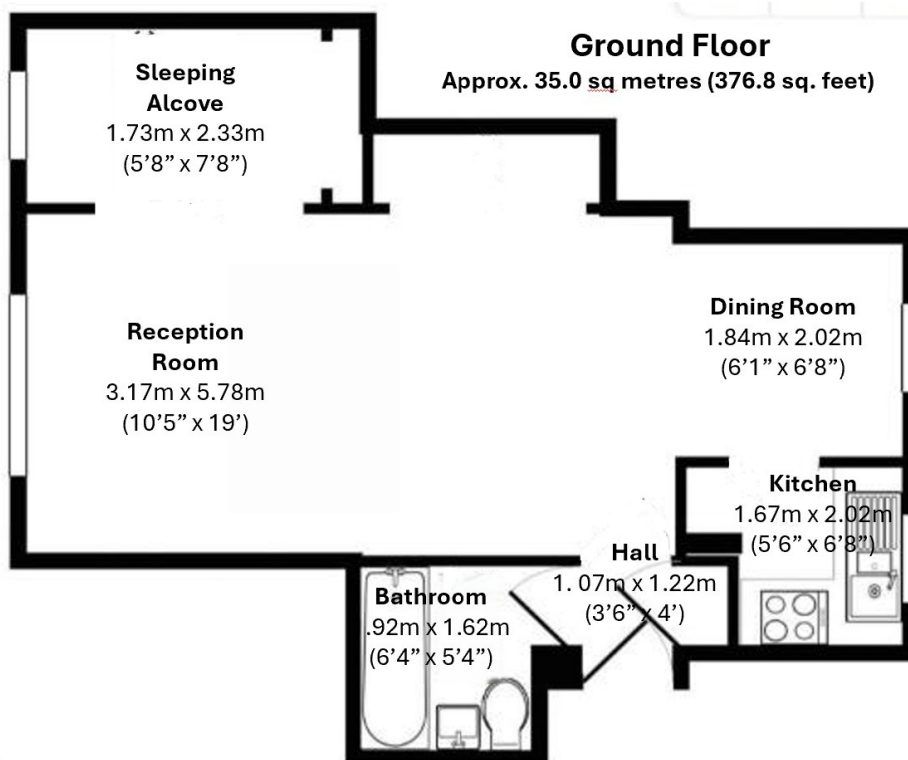

EPC GRAPH

Illustrations are for identification purposes only and are not to scale.
All measurements are a maximum and include wardrobes and bay windows where applicable.

Property type	Ground-floor flat
Total floor area	37 square metres

Rules on letting this property

Properties can be let if they have an energy rating from A to E.

You can read [guidance for landlords on the regulations and exemptions](#).

Energy rating and score

This property's energy rating is D. It has the potential to be C.

[See how to improve this property's energy efficiency](#).

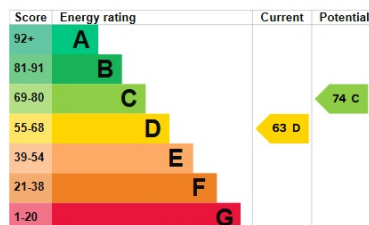

The graph shows this property's current and potential energy rating.

Properties get a rating from A (best) to G (worst) and a score. The better the rating and score, the lower your energy bills are likely to be.

For properties in England and Wales:

- the average energy rating is D
- the average energy score is 60

Disclaimer: The information displayed about this property comprises a property advertisement. 99home.co.uk (<http://www.99home.co.uk/>) will not make no warranty for the accuracy or completeness of the advertisement or any linked or associated information, and 99home has no control over the content. This property advertisement does not constitute property particulars, the property may offer to tenants in same condition as they have seen on time of the viewing. The information is provided and maintained by 99home.co.uk (<http://www.99home.co.uk/>)

Company registration number in England : 10469887 VAT: 263 3023 36
Copyright © 99Home Limited 2017. All rights reserved.