

1 Bed Flat In Academy Place Isleworth, England, TW7 5FE

£79,500





SHORT DESCRIPTION

Property Ref: 15746 Elegant One-Bedroom Ground Floor Apartment – Academy Place, Isleworth, TW7. Welcome to this beautifully presented ground-floor apartment, ideally situated in the sought-after Academy Place development in Isleworth. Perfectly blending modern comfort with a sense of tranquillity, this charming home offers an inviting living environment ideal for first-time buyers, professionals, or investors alike. The flat includes Private Parking. The property features a spacious living room filled with natural light, creating a warm and relaxing atmosphere — perfect for both entertaining and unwinding. The modern fitted kitchen complements the space beautifully, offering ample storage and contemporary finishes. The bedroom is well-proportioned and designed for comfort, while the stylish bathroom is finished to a high standard, providing both practicality and elegance. Set within a well-maintained development, residents enjoy landscaped communal gardens and secure surroundings. The location offers excellent connectivity — within easy reach of Isleworth and Osterley stations, local shops, cafes, and amenities, as well as great transport links into Central London and Heathrow Airport. This delightful property offers a wonderful opportunity to enjoy modern living in a prime West London location. Property Type: Flat Full selling price: £265000.00 Pricing Options: Shared ownership Tenure: Leasehold Percentage to be sold: 30% Share price: £79500.00 Monthly rent based on 30% share: £652.44 Remaining lease (In Years): 107 Yearly Ground Rent Cost: £0.00 Yearly Management Cost: £1793.00 Council tax band: C EPC rating: B Measurement: Bedrooms, Bathrooms, and Living Room Possession of the property: Occupied

1

Bed Room(s)

1

Bath Room(s)

1

Living Room(s)

FLOOR PLAN

Illustrations are for identification purposes only and are not to scale.
All measurements are a maximum and include wardrobes and bay windows where applicable.

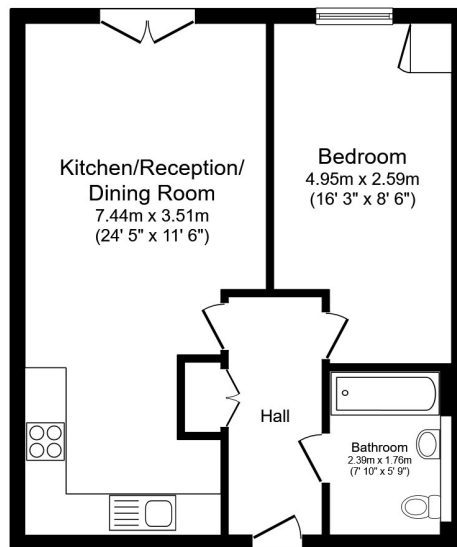

Total floor area 46.1 sq.m. (496 sq.ft.) approx

This floor plan is for illustrative purposes only. It is not drawn to scale. Any measurements, floor areas (including any total floor area), openings and orientation are approximate. No details are guaranteed, they cannot be relied upon for any purpose and they do not form part of any agreement. No liability is taken for any error, omission or misstatement. A party must rely upon its own inspection(s). Powered by www.focalagent.com

EPC GRAPH

Illustrations are for identification purposes only and are not to scale.
All measurements are a maximum and include wardrobes and bay windows where applicable.

Score	Energy rating	Current	Potential
92+	A		
81-91	B	81 B	81 B
69-80	C		
55-68	D		
39-54	E		
21-38	F		
1-20	G		

Disclaimer: The information displayed about this property comprises a property advertisement. 99home.co.uk (/) will not make no warranty for the accuracy or completeness of the advertisement or any linked or associated information, and 99home has no control over the content. This property advertisement does not constitute property particulars, the property may offer to tenants in same condition as they have seen on time of the viewing. The information is provided and maintained by 99home.co.uk (/)

