

3 Bed Semi-Detached Bungalow In Carnhell Road, Gwinear,, Hayle, TR27 5LB
£1,795 Monthly

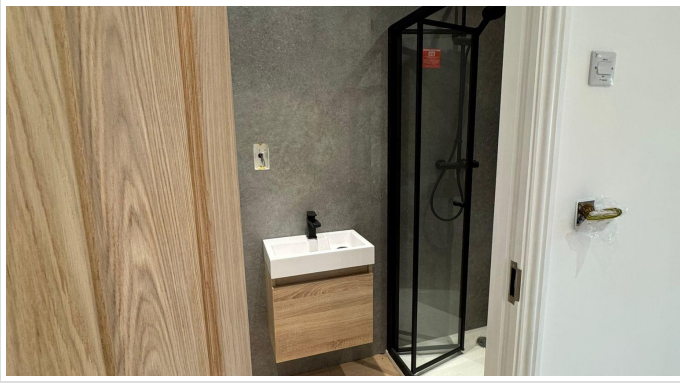



SHORT DESCRIPTION

Property Ref: 16025 We are proud to offer this delightful 4 bedroom, 2 bathroom terraced house in a great location. This property benefits from available road side parking, charming design features, with front and back garden access. Property is offered furnished or unfurnished (tenant can decide, price dependent). Property Type: Terraced Full renting price: £1795.00 Pricing Options: Fixed price Tenure: 12 months Council tax band: D EPC rating: C Outside Space: Patio Parking: Driveway Heating Type: Gas Central Heating Utilities Unincluded Unfurnished...

3

Bed Room(s)

3

Bath Room(s)

1

Living Room(s)

FLOOR PLAN

Illustrations are for identification purposes only and are not to scale.
All measurements are a maximum and include wardrobes and bay windows where applicable.

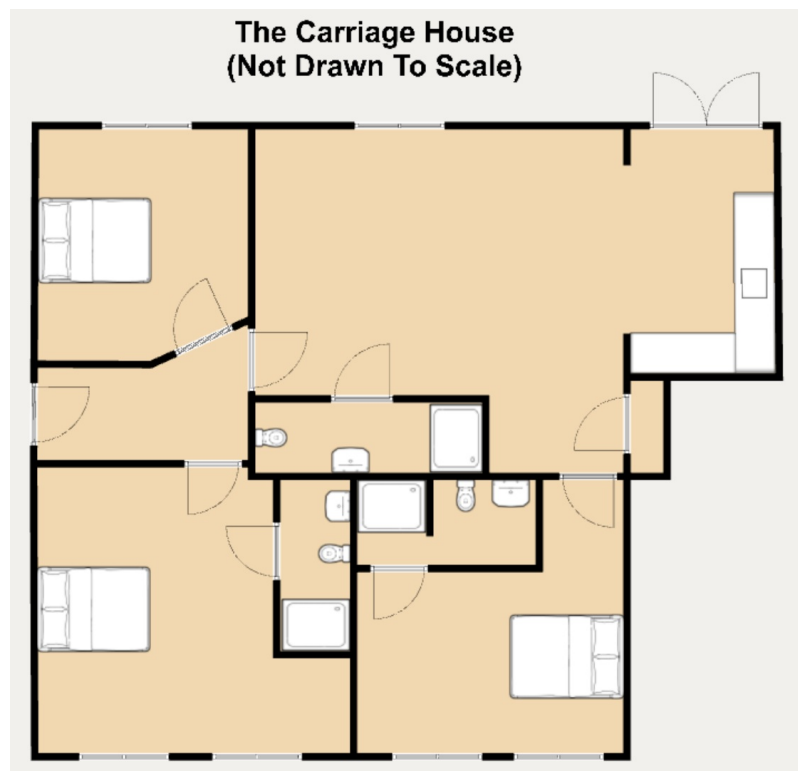

EPC GRAPH

Illustrations are for identification purposes only and are not to scale.
All measurements are a maximum and include wardrobes and bay windows where applicable.

Property type	Semi-detached house
Total floor area	235 square metres

Rules on letting this property

Properties can be let if they have an energy rating from A to E.

You can read [guidance for landlords on the regulations and exemptions](#).

Energy rating and score

This property's energy rating is C. It has the potential to be B.

[See how to improve this property's energy efficiency](#).



Disclaimer: The information displayed about this property comprises a property advertisement. 99home.co.uk (/) will not make no warranty for the accuracy or completeness of the advertisement or any linked or associated information, and 99home has no control over the content. This property advertisement does not constitute property particulars, the property may offer to tenants in same condition as they have seen on time of the viewing. The information is provided and maintained by 99home.co.uk (/)