

## 4 Bed Semi-Detached In Birmingham Road Midland, Dudley, DY1 4RF

£1,300 Monthly





## SHORT DESCRIPTION

Property Ref: 16106 Semi-Detached Four-Bedroom Home on Birmingham Road, Dudley Located on the popular Birmingham Road in Dudley, this well-presented semi-detached property offers generous living accommodation, ideal for families or professional tenants. The property comprises four well-proportioned bedrooms, one bathroom, and a spacious living room, providing comfortable and practical living space throughout. The home further benefits from gas central heating, ensuring warmth and efficiency all year round. Externally, the property features a private rear garden, perfect for outdoor relaxation or family use, along with convenient on-street parking to the front. Situated in a well-connected location, the property offers easy access to local amenities, schools, public transport links, and major road networks. Key Features: Semi-detached property Four bedrooms One bathroom One spacious living room Gas central heating Rear garden On-street parking Convenient Dudley location This property presents an excellent opportunity for comfortable family living in a sought-after area. Property Type: Semi-detached Full Renting price: £1300.00 Pricing Options: Fixed Price Tenure: 12 months Council tax band: A EPC rating: D Measurement: 949.9 sq.ft. Outside Space: Rear Garden Parking: On street Heating Type: Gas Central Heating -----



Bed Room(s)



Bath Room(s)



Living Room(s)

## FLOOR PLAN

Illustrations are for identification purposes only and are not to scale.  
All measurements are a maximum and include wardrobes and bay windows where applicable.

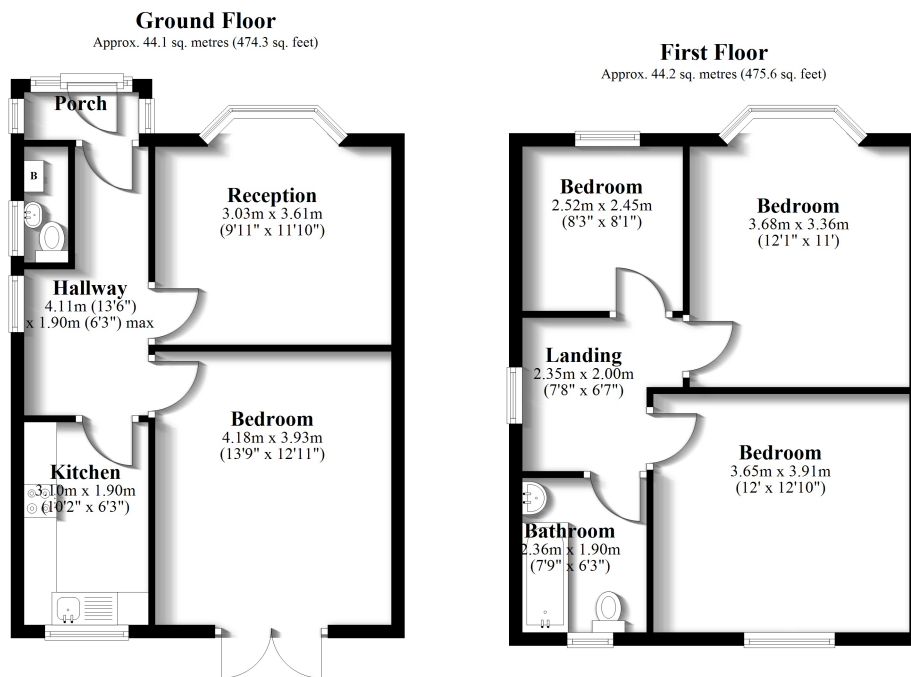

Total area: approx. 88.3 sq. metres (949.9 sq. feet)  
**Birmingham Road, Dudley DY1**

## EPC GRAPH

Illustrations are for identification purposes only and are not to scale.  
 All measurements are a maximum and include wardrobes and bay windows where applicable.

Property type	Semi-detached house
Total floor area	90 square metres

### Rules on letting this property

Properties can be let if they have an energy rating from A to E.  
 You can read [guidance for landlords on the regulations and exemptions](#).

### Energy rating and score

This property's energy rating is D. It has the potential to be C.

[See how to improve this property's energy efficiency.](#)

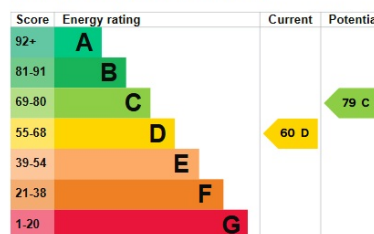

The graph shows this property's current and potential energy rating.

**Properties get a rating from A (best) to G (worst) and a score.** The better the rating and score, the lower your energy bills are likely to be.

For properties in England and Wales:

- the average energy rating is D
- the average energy score is 60

**Disclaimer:** The information displayed about this property comprises a property advertisement. 99home.co.uk (/) will not make no warranty for the accuracy or completeness of the advertisement or any linked or associated information, and 99home has no control over the content. This property advertisement does not constitute property particulars, the property may offer to tenants in same condition as they have seen on time of the viewing. The information is provided and maintained by 99home.co.uk (/)

