



99Home Ltd.
99Home Ltd,
Sutton Business Centre,
Restmor Way,
Wallington,
SM6 7AH,
Phone :0203 5000 999
Email
:info@99home.co.uk

2 Bed End Of Terrace In Heath Way , Horsham, RH12 5XT

£1,550 Monthly



Ref: 16486





SHORT DESCRIPTION

Property Ref: 16486 Delightful, fully refurbished and redecorated, two bedroom house in Horsham, with a south facing garden only 0.7 miles from the nearest train station. This end of terrace has a newly installed kitchen with breakfast bar and a completely new bathroom, both with stylish new cushion flooring. Throughout the rest of the house there are newly fitted, neutral coloured carpets. The sunny garden has a patio with a vine covered pergola to offer shade on hot summer days. The property also benefits from a garden shed and garage for further storage. Lounge 5.8 m x 3.8 m Kitchen 3.8 m x 2.5 m Porch 1.4 m x 1.1 m Bedroom 1 3.8 m x 3.2 m Bedroom 2 3.8 m x 2.5 m Bathroom 2.6 m x 1.45 m Landing 2.6 m x 1.2 m Property Type: End of Terrace Full Renting price: £1550.00 Pricing Options: No Status Tenure: 12 months Council tax band: C EPC rating: C Measurement: 678.126 sq.ft. Outside Space: Front Garden, Rear Garden, Enclosed Garden, Patio Parking: Garage, On street Heating Type: Gas Central Heating -----

2

Bed Room(s)

1

Bath Room(s)

1

Living Room(s)

FLOOR PLAN

Illustrations are for identification purposes only and are not to scale.
All measurements are a maximum and include wardrobes and bay windows where applicable.

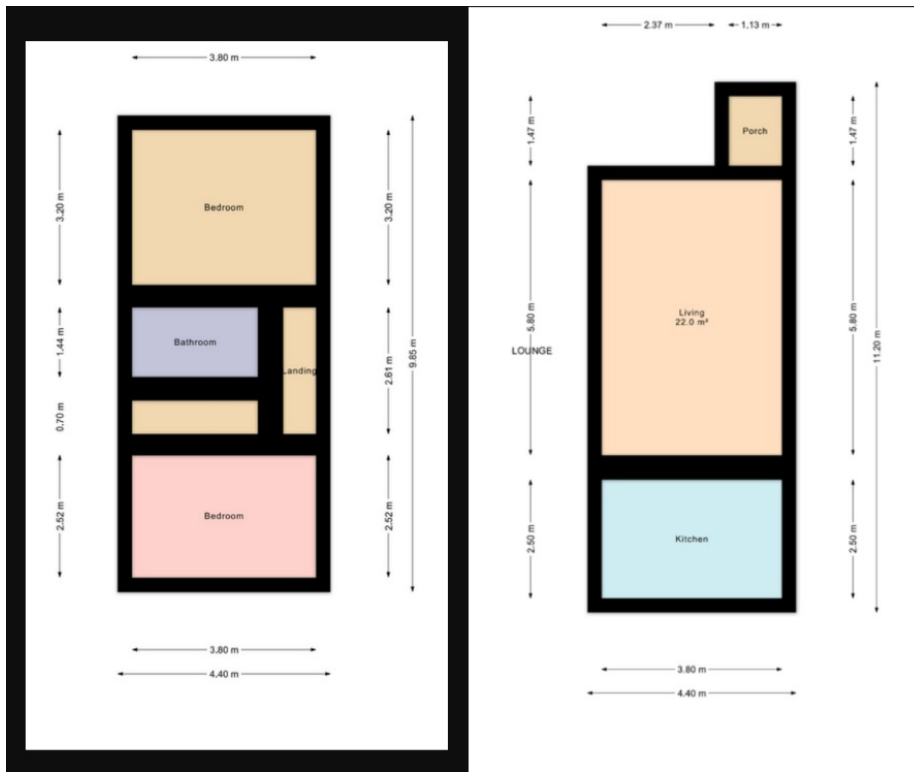

EPC GRAPH

Illustrations are for identification purposes only and are not to scale.
All measurements are a maximum and include wardrobes and bay windows where applicable.

Property type	End-terrace house
Total floor area	63 square metres

Rules on letting this property

Properties can be let if they have an energy rating from A to E.
You can read [guidance for landlords on the regulations and exemptions](#).

Energy rating and score

This property's energy rating is C. It has the potential to be C.
[See how to improve this property's energy efficiency](#).

Score	Energy rating	Current	Potential
92+	A		
81-91	B		
69-80	C	69 C	79 C
55-68	D		
39-54	E		
21-38	F		
1-20	G		

The graph shows this property's current and potential energy rating.

Properties get a rating from A (best) to G (worst) and a score. The better the rating and score, the lower your energy bills are likely to be.

For properties in England and Wales:

- the average energy rating is D
- the average energy score is 60

Disclaimer: The information displayed about this property comprises a property advertisement. 99home.co.uk (<http://www.99home.co.uk/>) will not make no warranty for the accuracy or completeness of the advertisement or any linked or associated information, and 99home has no control over the content. This property advertisement does not constitute property particulars, the property may offer to tenants in same condition as they have seen on time of the viewing. The information is provided and maintained by 99home.co.uk (<http://www.99home.co.uk/>)

