

2 Bed Terraced In Whickham Court Nottingham, Nottingham, NG2 2JW £170,000





SHORT DESCRIPTION

Property Ref: 16642 This bright and well-presented two bedroom terraced house is available to buy with no onward chain. It is ideally located in the popular area of The Meadows, within easy reach of Nottingham Railway Station, local shops in West Bridgford, and the delightful Victoria Embankment. It is ideal for first-time buyers, individuals and young families alike. The property is serviced by gas central heating and boasts a brand new combination boiler. There is ample in-built storage throughout the property. It benefits from courtyard frontage with ample permit parking, and is served by regular public transport links. Bedrooms: Two carpeted double bedrooms are situated on the first floor with ample room for storage. Bathroom: There is a spacious single bathroom with an over-bath shower. Reception rooms: The property boasts a bright and generously sized carpeted living room with double doors into the private rear garden. Kitchen: There is a galley kitchen with a large amount of storage and space for white goods, which is fitted with a gas hob and electric oven. Outdoor space: There is a private garden to the rear which is contained by a wooden fence. It includes a small lawn, paved seating area and several raised beds. To the front, there is a paved area with a secure bicycle lock-up and ample space for seating. Don't hesitate, get in touch today to arrange a viewing. Property Type: Terraced Full selling price: £170000.00 Pricing Options: Offers in the region of Tenure: Freehold Council tax band: A EPC rating: C Measurement: 624.307 sq.ft. Outside Space: Rear Garden, Enclosed Garden, Patio Parking: Permit, On street Heating Type: Double Glazing, Gas Central Heating Chain Sale or Chain Free: Chain free Possession of the property: Tenanted -----

2

Bed Room(s)

1

Bath Room(s)

1

Living Room(s)

FLOOR PLAN

Illustrations are for identification purposes only and are not to scale.
All measurements are a maximum and include wardrobes and bay windows where applicable.

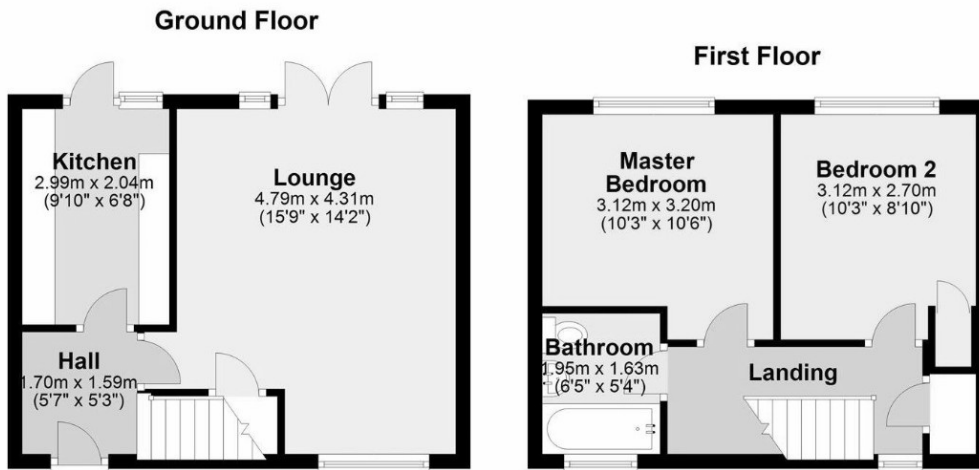

EPC GRAPH

Illustrations are for identification purposes only and are not to scale.
All measurements are a maximum and include wardrobes and bay windows where applicable.

Property type	Mid-terrace house
Total floor area	58 square metres

Rules on letting this property

Properties can be let if they have an energy rating from A to E.
You can read [guidance for landlords on the regulations and exemptions](#).

Energy rating and score

This property's energy rating is C. It has the potential to be B.
[See how to improve this property's energy efficiency](#).

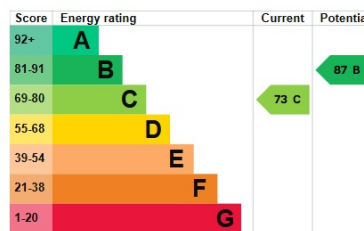

The graph shows this property's current and potential energy rating.

Properties get a rating from A (best) to G (worst) and a score. The better the rating and score, the lower your energy bills are likely to be.

For properties in England and Wales:

- the average energy rating is D
- the average energy score is 60

Disclaimer: The information displayed about this property comprises a property advertisement. 99home.co.uk (<http://www.99home.co.uk/>) will not make no warranty for the accuracy or completeness of the advertisement or any linked or associated information, and 99home has no control over the content. This property advertisement does not constitute property particulars, the property may offer to tenants in same condition as they have seen on time of the viewing. The information is provided and maintained by 99home.co.uk (<http://www.99home.co.uk/>)

