

3 Bed Flat In Elizabeth Gardens Acton, Acton, W3 7SL

£450,000





## SHORT DESCRIPTION

Property Ref: 17084 Bright and airy 1st Floor, 3 double bedroom property, freshly decorated and ready for immediate occupation! Completely refurbished in 2025. Situated in popular Acton Vale, with excellent transport facilities, parks, gyms, shops, cafes, etc. A beautiful home or a great rental investment! 755 sq.ft (701.sq.m) Property Type: Flat Full selling price: £450000.00 Pricing Options: Guide Price Tenure: Leasehold Remaining lease (In Year): 85 Yearly Ground Rent Cost: £10.00 Yearly Management Cost: £2000.00 Council tax band: C EPC rating: C Measurement:755 sq.ft. Possession of the property: Vacant.

3

Bed Room(s)

1

Bath Room(s)

1

Living Room(s)

## FLOOR PLAN

Illustrations are for identification purposes only and are not to scale. All measurements are a maximum and include wardrobes and bay windows where applicable.

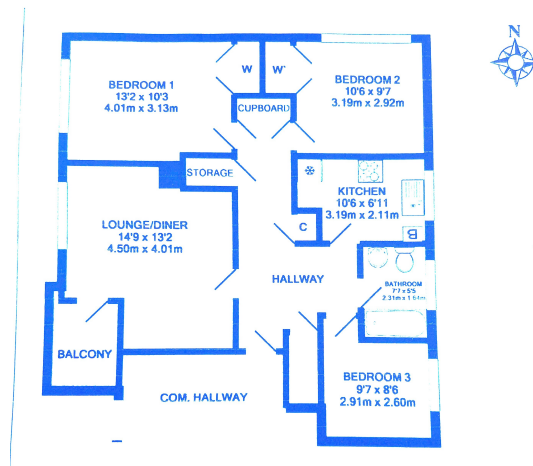

TOTAL APPROX. FLOOR AREA 755 SQ.FT. (70.1 SQ.M.)  
 Whilst every attempt has been made to ensure the accuracy of the floor plan contained here, measurements of doors, windows, rooms and any other items are approximate and no responsibility is taken for any error, omission or misstatement. This plan is for illustrative purposes only and should be used as such by any prospective purchaser. The services, systems and appliances shown have not been tested and no guarantee as to their operability or efficiency can be given.  
 Made with Metropix 1/2018

## EPC GRAPH

Illustrations are for identification purposes only and are not to scale. All measurements are a maximum and include wardrobes and bay windows where applicable.

## Energy efficiency rating for this property

This property's current energy rating is C. It has the potential to be C.

[See how to improve this property's energy performance.](#)

Score	Energy rating	Current	Potential
92+	A		
81-91	B		
69-80	C	73   c	79   c
55-68	D		
39-54	E		
21-38	F		
1-20	G		

The graph shows this property's current and potential energy efficiency.

Properties are given a rating from A (most efficient) to G (least efficient).

Properties are also given a score. The higher the number the lower your fuel bills are likely to be.

For properties in England and Wales:

the average energy rating is D  
the average energy score is 60

---

**Disclaimer:** The information displayed about this property comprises a property advertisement. 99home.co.uk (<http://www.99home.co.uk/>) will not make no warranty for the accuracy or completeness of the advertisement or any linked or associated information, and 99home has no control over the content. This property advertisement does not constitute property particulars, the property may offer to tenants in same condition as they have seen on time of the viewing. The information is provided and maintained by 99home.co.uk (<http://www.99home.co.uk/>)

---

Company registration number in England : 10469887 VAT: 263 3023 36  
Copyright © 99Home Limited 2017. All rights reserved.