

2 Bed Flat In Heath Court Stanley Close, New Eltham, SE9 2BB £1,700 Monthly





SHORT DESCRIPTION

Property Ref: 4002 Furnished two bedroom top (second) floor apartment (no lift), a short walk from New Eltham train station. The flat comprises of two double bedrooms, modern bathroom, spacious reception room and kitchen with white goods. There are local shops and takeaways nearby. No smokers No pets Property Type: Flat Full Renting price: £1700.00 Pricing Options: Guide Price Tenure: 12 months Council tax band: C EPC rating:C Measurement:527.432 sq.ft. Outside Space: Communal Garden Parking: Residents Heating Type: Electric Heating -----

2

Bed Room(s)

1

Bath Room(s)

1

Living Room(s)

FLOOR PLAN

Illustrations are for identification purposes only and are not to scale.
All measurements are a maximum and include wardrobes and bay windows where applicable.

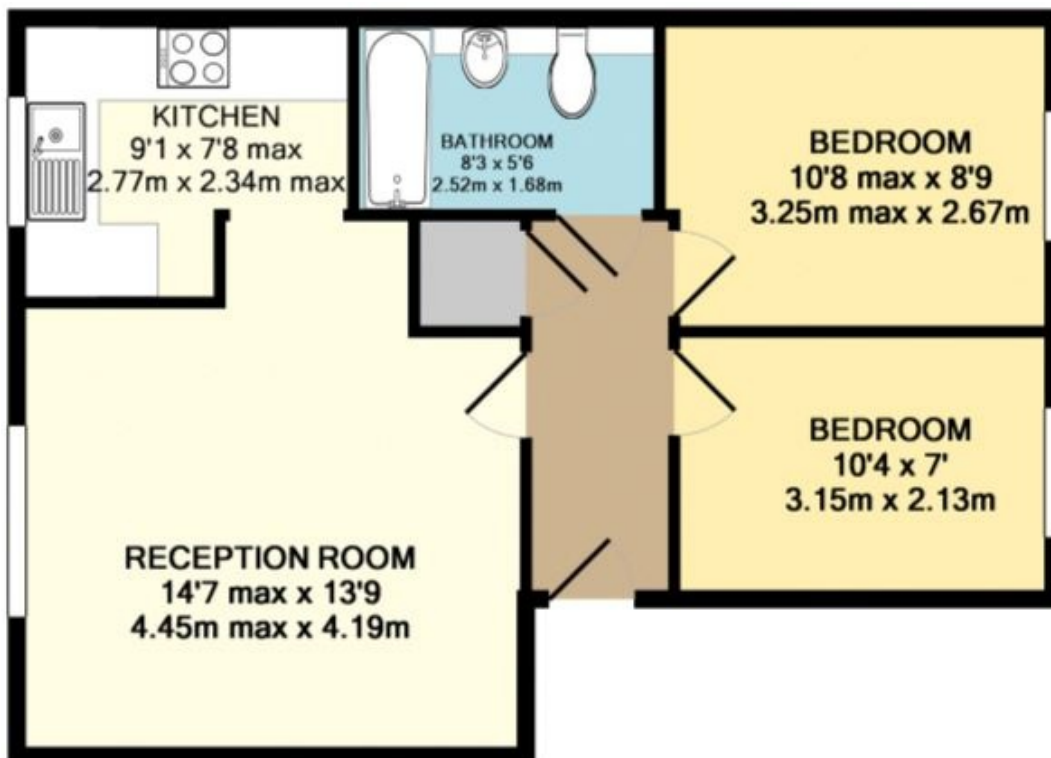

EPC GRAPH

Illustrations are for identification purposes only and are not to scale.
All measurements are a maximum and include wardrobes and bay windows where applicable.

Property type	Top-floor flat
Total floor area	49 square metres

Rules on letting this property

Properties can be let if they have an energy rating from A to E.

You can read [guidance for landlords on the regulations and exemptions](#).

Energy rating and score

This property's energy rating is C. It has the potential to be C.

[See how to improve this property's energy efficiency](#).



The graph shows this property's current and potential energy rating.

Properties get a rating from A (best) to G (worst) and a score. The better the rating and score, the lower your energy bills are likely to be.

For properties in England and Wales:

- the average energy rating is D
- the average energy score is 60

Disclaimer: The information displayed about this property comprises a property advertisement. 99home.co.uk (/) will not make no warranty for the accuracy or completeness of the advertisement or any linked or associated information, and 99home has no control over the content. This property advertisement does not constitute property particulars, the property may offer to tenants in same condition as they have seen on time of the viewing. The information is provided and maintained by 99home.co.uk (/)

Company registration number in England : 10469887 VAT: 263 3023 36
Copyright © 99Home Limited 2017. All rights reserved.