

## 2 Bed Flat In Ladbroke Cr , Notting Hill, W11 1PS

£2,499 Monthly





## SHORT DESCRIPTION

[Property Ref: 4531] A 2 Bed, Notting Hill, W11. Amazing Location! FIRST FLOOR Amazing Location! 30 Sec walk to multiple Shops, Supermarkets, Bars, Restaurants. 1 minute walk to Ladbroke Grove Tube Station. 2 minutes walk to Portobello Road Market. 3 minutes to the Chic Boutiques, Bars, and Restaurants of Notting Hill. A Fully refurbished 2 Double Bedroom flat in a lovely FIRST FLOOR Victorian conversion, in an imposing white stucco fronted building. Boasting 3 meter high ceilings, large sash windows, and attractive features. Modern Bathroom. Modern Kitchen with Granite worktops Westfield Shopping Centre, Notting Hill Gate, Holland, and Hyde Parks are also within easy walking distance. The bus stop/ night buses are only one minute walk from the flat. Tesco and Sainsburys are close by as well and opened till midnight. Large lounge, big eat-in Kitchen. Ideal for a couple or 2 sharers. Available furnished..... Property Type: Flat Full Renting price: £2499.00 Pricing Options: Fixed Price Tenure: 6 month Council tax band: D EPC rating:C Measurement: 365.973 sq.ft. Outside Space: N/A Parking: Residents Heating Type: Gas central Heating -----

2

Bed Room(s)

1

Bath Room(s)

1

Living Room(s)

## FLOOR PLAN

Illustrations are for identification purposes only and are not to scale.  
All measurements are a maximum and include wardrobes and bay windows where applicable.

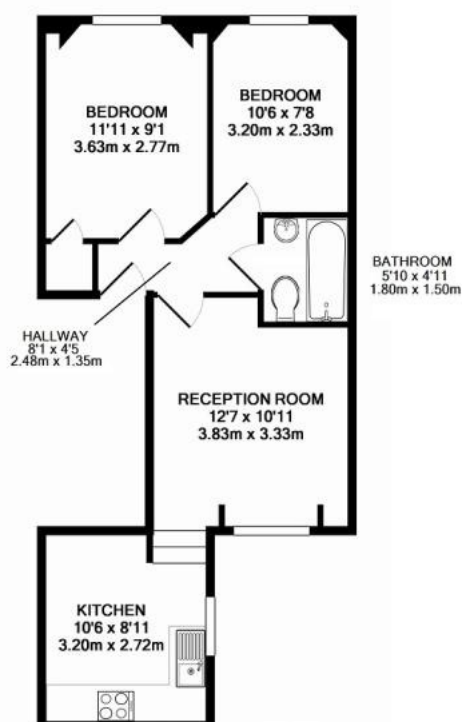

# EPC GRAPH

Illustrations are for identification purposes only and are not to scale.  
All measurements are a maximum and include wardrobes and bay windows where applicable.

Property type	Mid-floor flat
Total floor area	34 square metres

## Rules on letting this property

Properties can be let if they have an energy rating from A to E.

You can read [guidance for landlords on the regulations and exemptions](#).

## Energy rating and score

This property's energy rating is C. It has the potential to be C.

[See how to improve this property's energy efficiency.](#)

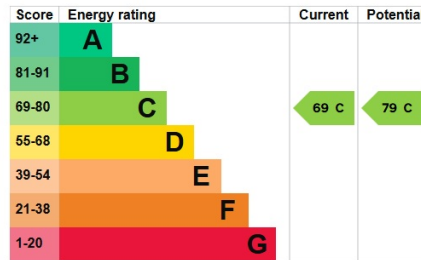

The graph shows this property's current and potential energy rating.

**Properties get a rating from A (best) to G (worst) and a score.** The better the rating and score, the lower your energy bills are likely to be.

**Disclaimer:** The information displayed about this property comprises a property advertisement. 99home.co.uk (/) will not make no warranty for the accuracy or completeness of the advertisement or any linked or associated information, and 99home has no control over the content. This property advertisement does not constitute property particulars, the property may offer to tenants in same condition as they have seen on time of the viewing. The information is provided and maintained by 99home.co.uk (/)

Company registration number in England : 10469887 VAT: 263 3023 36  
Copyright © 99Home Limited 2017. All rights reserved.